

# Coaldale Nurseries Ltd.

11 km east of Lethbridge  
on Hwy No. 3

Box 1267,  
Coaldale, AB T1M 1N1  
Phone: 403-345-4633 • Fax: 403-345-2866  
E-mail: [info@coaldalenurseries.ca](mailto:info@coaldalenurseries.ca)  
Website: [www.coaldalenurseries.ca](http://www.coaldalenurseries.ca)

## OUR 49th YEAR



## 2020 Price List

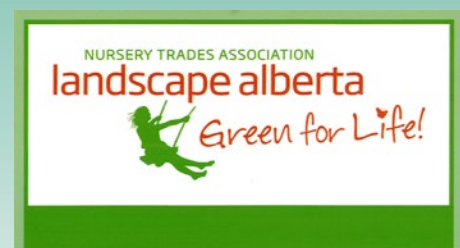

We are pleased to present you with our 2020 Price List. All plant material listed is first class quality and is suitable and hardy for this area. Listed are a large variety of trees, shrubs and evergreens, but should there be a plant you like that is not listed, please ask us about it. We may have a few in stock, or we may be able to bring it in for you if we feel that plant is hardy.

We have a trained staff looking forward to serving you in the coming season.

## OUR GUARANTEE

WE WILL REPLACE ONCE, FREE OF CHARGE, ANY NURSERY STOCK SOLD BY US AT THE PURCHASE PRICE THAT FAILS TO LIVE, PROVIDING YOU HAVE CAREFULLY FOLLOWED THE DIRECTIONS FOR PLANTING AND CARE AND PROVIDED WE ARE NOTIFIED WITHIN ONE YEAR OF DATE OF SALE. WARRANTY DOES NOT COVER TREES OR SHRUBS WHICH FAIL TO LIVE DUE TO SEVERE WEATHER, MACHINE OR ANIMAL DAMAGE.

NO ADJUSTMENTS WILL BE MADE WITHOUT THE ORIGINAL SALE SLIP.

PRICES SUBJECT TO CHANGE WITHOUT NOTICE

Delivery and or planting can be arranged for a fee.

We should have all the varieties in stock but maybe not in all sizes listed.

### HOW TO PLANT CONTAINER-GROWN PLANTS

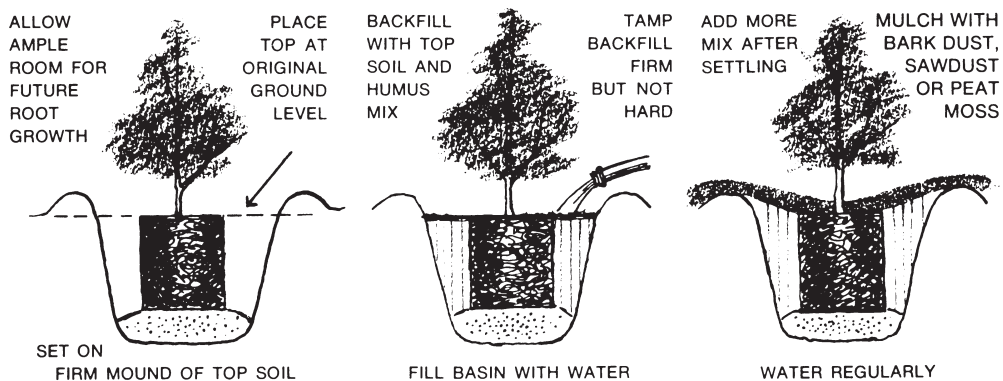

Our staff looks forward to helping you with your plant needs this year.



**BUSINESS HOURS:**

	April	May - June	July - October
Monday - Tuesday	9:00 a.m. - 6:00 p.m.	9:00 a.m. - 6:00 p.m.	9:00 a.m. - 5:00 p.m.
Wednesday - Friday	9:00 a.m. - 6:00 p.m.	9:00 a.m. - 8:00 p.m.	9:00 a.m. - 5:00 p.m.
Saturday	9:00 a.m. - 5:00 p.m.	9:00 a.m. - 5:00 p.m.	9:00 a.m. - 5:00 p.m.
Sunday	Closed	Closed	Closed

**We are closed November through March. Open by appointment. Feel free to call us if you have any questions.**

## **COLORADO GREEN SPRUCE**

### **PICEA PUNGENS**

Medium to large evergreen. Needles deep green to blue green. Very useful as an evergreen hedge or windbreak.

## **COLORADO BLUE SPRUCE**

### **PICEA PUNGENS GLAUCA**

Beautiful ornamental tree with blue needles. Very hardy.

## **SCOTS PINE**

### **PINUS SYLVESTRIS**

Very hardy, fast-growing evergreen. Has short rigid, bluish-green needles. Very large tree.

## **MOUNTAIN PINE**

### **PINUS MUGO UNCINATA**

Very compact upright evergreen growing up to 13 ft. in height.

## **PONDEROSA PINE**

Large tree with long green needles.

### **PRICES FOR THE ABOVE EVERGREENS**

1 gal. \$13.95    5 gal. \$45.00    10 gal. \$99.95

PINE & SPRUCE TREES \$30.00/ft.



## **OHLENDORFI DWARF SPRUCE**

### **PICEA ABIES 'OHLENDORFII'**

Very slow growing, conical shaped green spruce. Much hardier than dwarf Alberta Spruce.

## **DWARF BLUE SPRUCE**

### **PICEA PUNGENS GLAUCA 'MONTGOMERY'**

Dwarf, slow growing spruce, very intense blue needles. Very hardy.

## **GLOBE BLUE SPRUCE**

### **PICEA PUNGENS GLAUCA 'GLOBOSA'**

Dwarf globe shaped evergreen, that holds blue color during the winter.

## **COLUMNAR BLUE SPRUCE**

### **PICEA UNGENS 'FASTIGIATA'**

Upright columnar spruce with intense blue growth.

## **HOOPSI BLUE SRUCE**

### **PICEA PUNGENS GLAUCA 'HOOPSI'**

This is one of the most intense blue spruce available. It is grafted so every one is the same color. Ideal for lawn specimen.

## **DWARF BALSAM FIR**

### **ABIES BALSEMEA NANA**

Very slow growing globe shaped evergreen. Very suitable for rock gardens. Does well in partial shade.

## **BRISTLE CONE PINE**

### **PINUS ARISTATA**

Very slow growing pine. Dense, bushy, symmetrical, narrow conical tree with a mature look.

### **PRICES FOR THE ABOVE**

2 gal. \$50.00    5 gal. \$96.50    10 gal. \$195.00  
25 gal. \$375.00





**WICHITA BLUE JUNIPER**

**COLOGREEN JUNIPER**

**JUNIPERUS SCOULORUM 'COLOGREEN'**

Bright green even growing foliage fills out to compact upright, cone-like habit.

**MOONGLOW JUNIPER**

**JUNIPERUS SCOULORUM 'MOONGLOW'**

Outstanding medium-sized evergreen with broad upright pyramidal shape. Intense blue foliage all year long.

**MEDORA JUNIPER**

**JUNIPERUS SCOULORUM 'MEDORA'**

Hardy, very compact upright juniper will stand up in windy conditions.

**WICHITA BLUE JUNIPER**

**JUNIPERUS SCOULORUM 'WITCHITA BLUE'**

One of the best blue upright junipers for this area. Much more compact than Blue Haven AND JUST AS HARDY. Makes good hedge or screen.

**PRICES FOR UPRIGHT JUNIPERS**

5 gal. \$85.95 10 gal. \$132.95

**CEDARS**

**BRANDON CEDAR**

**THUJA OCCIDENTALIS PYRAMIDALIS 'BRANDON'**

Much hardier than the above and a little slower growing. For hedge or screen plant 120 cm apart.

**HOLMSTRUP CEDAR**

**THUJA OCCIDENTALIS 'HOLMSTRUP'**

Slow growing, densely branched conical form, 5-7' high, 2-3' wide. Excellent foundation plant for protected areas only.

**PRICES FOR CEDARS**

2 gal. \$27.95 5 gal. \$39.95 7 gal. \$49.95



**HOLMSTRUP CEDAR**

**LITTLE GEM CEDAR**

**THUJA OCCIDENTALIS 'LITTLE GEM'**

Compact globe shaped shrub prized for it's dark green foliage.

**DWARF GLOBAL CEDAR**

**THUJA OCCIDENTALIS LITTLE GIANT**

Light green foliage, very dwarf and compact. Suitable for foundation planting.

**HETZ MIDGET DWARF GLOBAL CEDAR**

**THUJA OCCIDENTALIS HETZ MIDGET**

Extremely slow growing, dark green foliage. Prices may be slightly higher.

**GLOBE CEDAR**

**THUJA OCCIDENTALIS WOODWARDII**

Light green foliage, much larger than the dwarf varieties.

**PRICES FOR CEDARS ON THIS PAGE**

2 gal. \$27.95    5 gal. \$39.95



**LITTLE GIANT DWARF GLOBAL CEDAR**



**MUGO PINE**

**NEST SPRUCE**

**PICEA ABIES 'NIDIFORMIS'**

A dwarf, dense, flat topped growing evergreen shaped in the form of a bird's nest. DOES WELL IN THE SHADE.

**MUGO PINE**

**PINUS MUGO MUGHUS**

A very hardy, large shrub-like evergreen with dark green needles. Pinch candles about the first week in June to keep compact.

**DWARF MUGO PINE**

**PINUS MUGO PUMILIO**

Same as above, but much dwarfer and more compact.

**PRICES FOR THE ABOVE**

2 gal. \$27.95    5 gal. \$44.95

**SLOWMOUND MUGO PINE**

**PINUS MUGO 'SLOW MOUND'**

Low, globose mound of dense green needles. Low maintenance.

2 gal. \$39.95    5 gal. \$59.95



**JUNIPERS AS GROUND COVER**

**SCANDIA JUNIPER**

**JUNIPERUS SABINA SCANDIA**

Low spreading form to 50 cm in height. Holds color well during winter.

**TAMARISK JUNIPER**

**JUNIPERUS SABINA TAMARISCIFOLIA**

Spreading with a mounting habit to 50 cm in height. Blue green foliage. Widely used with bark, gravel and volcanic rock.

**BUFFALO JUNIPER**

**JUNIPERUS SABINA 'BUFFALO'**

Slow and low growing juniper with dark green needles. Grows 25 cm high.

**PRICES FOR JUNIPERS ON THIS PAGE**

2 gal. \$27.95    5 gal. \$44.95

**JUNIPERS MAKE  
GOOD  
GROUND COVER**

***The sabina selection of junipers do very well in both sun and shade. They are extremely hardy for our Southern Alberta climate.***

**SAVIN JUNIPER**

**JUNIPERUS SABINA 'SAVIN'**

Very hardy green juniper, good for foundation planting. Grows to about 1 metre in height.

**ARCADIA JUNIPER**

**JUNIPERUS SABINA 'ARCADIA'**

Low spreading evergreen that grows to about 60 cm in height. Stays green in winter.

**BLUE DANUBE JUNIPER**

**JUNIPERUS SABINA 'BLUE DANUBE'**

Fast, low growing juniper with blue green needles. Will grow 60 cm in height.

**BROADMOOR JUNIPER**

**JUNIPERUS SABINA 'BROADMOOR'**

Very neat and low spreading plant with bright green foliage, good for ground cover.

**CALGARY CARPET JUNIPER**

**JUNIPERUS SABINA 'CALGARY CARPET'**

A selection from Scandia Juniper. It is much lower in height and more compact. Slow growing, very suitable for small areas.



**BROADMOOR JUNIPER**

## **BLUE CHIP JUNIPER**

### **JUNIPERUS HORIZONTALIS BLUE CHIP**

Silver blue foliage on low mounting branches. Needs full sun.

## **BLUE RUG JUNIPER**

### **JUNIPERUS HORIZONTALIS 'WILTONI'**

One of the finest and hardiest trailing junipers. Will cascade over rocks and retaining walls. Has silver blue needles in summer and purple in winter.

## **PRINCE OF WALES JUNIPER**

### **JUNIPERUS HORIZONTALIS 'PRINCE OF WALES'**

Parent plant was found west of High River. Very low and slow growing. Suitable as ground cover in small areas. It likes the sun.

## **HUGHES JUNIPER**

### **JUNIPERUS HORIZONTALIS 'HUGHES'**

Very fine growing plant, has a very large spread and therefore is an excellent ground cover for large areas. Needles are silver blue. **NEEDS FULL SUN.**

## **ANDORA JUNIPER**

### **JUNIPERUS HORIZONTALIS 'PLUMOSA'**

Very low creeping juniper. Fast growing, turns purple in winter. **NEEDS FULL SUN.**



**BLUE RUG JUNIPER**

## **GOLD COAST JUNIPER**

### **JUNIPERUS CHINENSIS AUREA**

Very compact juniper with outstanding gold like foliage. Due to its slow growth habit, it hardly needs any pruning.

## **MINT JULIP JUNIPER**

### **JUNIPERUS CHINENSIS 'MINT JULIP'**

This plant will stand out in any grouping on account of its mint green foliage and handsome vase shape appearance.

## **BLUE STAR JUNIPER**

### **JUNIPERUS SQUAMATA 'BLUE STAR'**

Very slow and compact grower, suitable for small areas. Does best in partial shade. Has very neat appearance. Prices may be slightly higher.

## **PRICES FOR JUNIPERS ON THIS PAGE**

2 gal. \$27.95    5 gal. \$44.95



**HUGHES JUNIPER**





**EUROPEAN WHITE BIRCH CLUMP.**

Medium sized tree; white bark with multi-stem.

**THE BIRCH TREES CAN ONLY BE PRUNED IN THE MONTH OF JULY.**

**PRICES FOR TREES ON THIS PAGE**

5 gal. \$69.95    7 gal. \$98.95    10 gal. \$129.95  
15 gal. \$179.95

Larger sizes available.  
Prices on request.

**CUTLEAF WEeping BIRCH**

**AMERICAN ELM  
ULMAS AMERICANA**

Very hardy, long lived tree. Upright growing habit when young, more spreading when mature.

**BRANDON ELM  
ULMUS AM 'BRANDON'**

A selection out of the American Elms for its ascending and more evenly growth habit. Good fast growing tree.

**CUTLEAF WEeping BIRCH  
BETULA PENDULA LACINIATA**

The most graceful of all the weeping trees, the branches are very long and slender, giving the tree an intense weeping habit. AVAILABLE IN SINGLE OR MULTI-STEM.

**EUROPEAN WHITE BIRCH  
BETULA PENDULA ALBA**

Medium sized tree; the white bark makes it an outstanding tree in the summer and winter.



**BRANDON ELM**

## **THE FLOWERING CRABS**

The crabapple is one of the most gorgeous of spring flowering trees. It is often confused with the flowering cherry or wrongly called so. It deserves more wide-spread planting, and there are many varieties.

**DOLGO** - An upright grower with white flowers. The fruit is scarlet and excellent for jelly. Very hardy.

**GLADIATOR** - Ornamental tree with a profusion of bright pink flowers. Stately upright crown.

**JAN KUPERUS** - Fast grower with reddish pink flowers. Much like Almey, but hardier.

**MAKAMIK** - Very hardy tree with pink flowers and bronze foliage.

**BIG RIVER** - Very hardy tree with pyramidal growth habit and pink flowers.

**ROSTERN CRAB** - A very narrow upright growing tree. It has a spread of about 1.5 m. White flowers and green foliage.

**SPRING SNOW** - Attractive, heat tolerant, flowering ornamental tree. Fragrant white flowers.

**THUNDERCHILD** - Similar to Royalty, but had deep pink flowers. Seems to be more resistant to fireblight. Purple foliage.

**SELKIRK** - Deep purplish pink blossoms.

### **PRICES FOR TREES ON THIS PAGE**

5 gal \$69.95 7 gal \$93.95 10 gal \$129.95 15 gal \$179.95



### **MAYDAY TREE**

### **MUCKLE PLUM**

#### **PRUNUS X NIGRELLA 'MUCKLE'**

Has bright pink flowers in early spring, and green foliage. Tree is upright and oval shaped.

### **MAYDAY TREE**

#### **PRUNUS PADUS**

Also called European bird cherry. Vigorous growing tree to medium height. Rounded crown and is covered with white blossoms in May. Also available in multi-stem.

### **AMUR CHERRY**

#### **PRUNUS MAACKII**

Medium growing tree with attractive golden brown, flaking bark. The flowers are white.

### **SCHUBERT CHERRY**

#### **PRUNUS VIRG. SCHUBERT**

Also called Canada Red Cherry. Beautiful small to medium sized tree. The leaves are green when they appear in spring, later when mature they turn to purple.

### **PINCHERRY**

#### **PRUNUS PENNSYLVANICA**

Small ornamental tree to about 5 meters in height. Reddish brown bark. Covered with white flowers in late May. Dark green glossy leaves. Fruit is bright red.



**SILVER CLOUD MAPLE**  
**ACER SACCHARINUM 'SILVER CLOUD'**

Medium green foliage with silvery undersides.

**SIENNA GLEN MAPLE**  
**ACER X FREEMANII 'SIENNA'**

Well branched pyramidal form with green foliage turning yellow/red in fall.

**TOBA HAWTHORNE**  
**CRATEGUS MORDENESIS TOBA**

Small ornamental tree. Flowers come out white and later turn pink.

**SNOWBIRD HAWTHORNE**  
**CRATEGUS MORDENESIS SNOWBIRD**

Small tree to about 5 metres tall, white flowers.

**OHIO BUCKEYE**  
**AESCLUSUS GLABRA**

Slow growing dwarf tree.



**IVORY SILK TREE LILAC**

**JAPANESE TREE LILAC**  
**SYRINGA RETICULATA**

Small tree with creamy white flowers.

**BURR OAK**  
**QUERCUS MACROCARPA**

A slow growing tree until established. Very hardy. The corky bark is very attractive.

**LITTLE LEAF LINDEN**  
**TILIA CORDATA**

Medium sized tree with dark glossy leaves.

**DROPMORE LINDEN**  
**TILIA FLAVESCENS 'DROPMORE'**

This tree is an attractive tree for ornamental or shade purposes. Not recommended for dry areas.

**IVORY SILK TREE LILAC**  
**SYRINGA RETICULATA 'IVORY SILK'**

Upright, compact oval tree with creamy white flowers in early summer.

**PRICES FOR THE ABOVE TREES**

5 gal \$69.95 7 gal \$93.95 10 gal \$129.95  
15 gal \$179.95



**LITTLE LEAF LINDEN**

**HOT WINGS MAPLE**

**ACER TATARICUM 'GARR ANN'**

Graceful upright spreading habit. Lush green foliage turns yellow then red in fall.

**AMUR MAPLE**

**ACER GINNALA**

A small shrub-like tree with rounded crown. Deep green glossy leaves, which usually turn red in fall.

**MANITOBA MAPLE**

**ACER NEGUNDO**

Large, fast growing tree.

**RUSSIAN OLIVE**

**ELEAGNUS ANGUSTIFOLIA**

Beautiful ornamental tree with silver foliage. Very drought resistant and will tolerate poor soils.

**QUAKIN ASPEN**

**POPULUS TREMULA**

**SWEDISH COLUMNAR ASPEN**

**POPULUS TREMULA ERECTA**

Very narrow erect growing tree, more ornamental than Tower Poplar.

**PRICES FOR THE ABOVE TREES**

2 gal. \$27.95 5 gal. \$69.95 7 gal. \$93.95 10 gal. \$129.95



**LAUREL LEAF WILLOW**

***Plant a tree for the future...***



**TOWER POPLAR**

**FOR WINDBREAK TREE PRICES SEE ATTACHED LIST**

**TOWERING POPLAR**

**POPULUS CAN. 'TOWER'**

Hardy dense columnar tall tree. Medium to large size.

**BROOKS POPLAR**

**POPULUS X BROOKS**

Fast growing shade and windbreak tree.

**BROWN TWIG POPLAR**

**POPULUS TRISTIS**

Tree with very fragrant, balsamic buds. A fast growing wide spreading tree.

**SARGENT POPLAR**

**POPULUS DELTOIDES**

This is a male selection, so it will not produce cotton. Branches are strong, therefore not susceptible to wind damage. Has a long life span.

**LAUREL LEAF WILLOW**

**SALIX PENTANDRA**

A fast growing large shade tree. The dark green glossy leaves are very attractive.

**PRAIRIE CASCADE WEeping WILLOW**

**SALIX PENTANDRA X SEPULCRALIS 'PRAIRIE CASCADE'**

NEW introduction from Morden Manitoba and tested in different locations in Alberta. We find this weeping willow hardy for the Prairies.

**PRICES FOR THE ABOVE TREES**

2 gal. \$26.95 5 gal. \$69.95 7 gal. \$93.95 10 gal. \$129.95 15 gal. \$179.95

## **EXCELL GREEN ASH**

Very hardy seedless selection. Requires little pruning.

## **PRAIRIE SPIRE GREEN ASH**

### **FRAXINUS PENNSYLVANICA 'RUGBY'**

Narrow pyramidal tree that becomes more oval with age. Seedless.

## **NORTHERN TREASURE ASH**

### **FRAXINUS 'NORTHERN TREASURE' PPAF**

Has an upright, vigorous growth habit with green foliage turning orange-yellow in fall.

## **FALL GOLD BLACK ASH**

### **FRAXINUS NIGRA FALLGOLD**

A vigorous grower with strong crotches and dark green foliage. It is seedless and the leaves turn golden yellow in fall.

## **PRICES FOR THE ABOVE ASH TREES**

5 gal. \$69.95 7 gal. \$93.95 10 gal. \$129.95 15 gal. \$179.95

Larger sizes are available.



**AMERICAN MOUNTAIN ASH**

## **AMERICAN MOUNTAIN ASH**

### **SORBUS AMERICANA**

Small tree with a rounded crown. Well known for its red berries in the fall, and will attract birds.

AVAILABLE IN SINGLE OR MULTI-STEM.

## **EUROPEAN MOUNTAIN ASH**

### **SORBUS AUCUPARIA**

Medium sized tree, more upright in growth than the American Mountain Ash. Berries are orange to red. Leaves will turn red in fall. Also available in multi-stem.

## **RUSSIAN MOUNTAIN ASH**

### **SORBUS AUCUPARIA 'ROSSICA'**

A pyramid grower, nice fall coloring. Widely used as a boulevard tree on account of its shape.

## **PYRAMID MOUNTAIN ASH**

### **SORBUS AUCUPARIA 'FASTIGATA'**

A slow growing columnar tree with close erect stems. Has large dark green leaves and the berries are waxed red.

## **PRICES FOR THE ABOVE TREES**

5 gal. \$69.95 7 gal. \$93.95 10 gal. \$129.95 15 gal. \$179.95



**GREEN ASH**

***Be environmentally friendly -- plant a tree!***



**SCHUBERT CHERRY**

Most potted trees available in this catalogue are also available in caliper size.

Caliper means thickness of the stem. These trees are large, and grown locally in our own fields in Southern Alberta.

Caliper trees are dug and put into wire baskets.

Trees are priced according to caliper size.

Contact us for pricing.



**COLORADO SPRUCE**

## TOP GRAFTED TREES

Sometimes a variety will not form a trunk or stem strong enough to support the head or top of a tree. Then a common tree with a strong stem will be cut off at the height of 1.5 - 2 meters and the special variety will be grafted on this common tree at that height. These dwarf trees are very attractive and suitable in courtyards, rock gardens, and around waterfalls. They take up very little space and can be surrounded with different ground covers.

### YOUNGS WEeping BIRCH BETULA PENDULA YOUNGII

A small tree with dome-shaped or mushroom head. Bark is white. Not recommended as lawn specimen.

### GLOBE CARAGANA CARRAGANA FRUTEX GLOBOSO

Small tree with round head. Leaves out very early in spring. Yellow flowers.

### PRICES FOR TOP GRAFTED TREES

5 gal. \$82.95 7 gal. \$119.95 10 gal. \$129.95

### WALKER WEeping CARAGANA CARAGANA AB. 'WALKER'

Very lacy looking tree with fern-like foliage. Branches will cascade straight down. Yellow flowers.

### FERNLEAF CARAGANA CARAGANA AB. LOBERGII

Semi-weeping tree with fern-like foliage. Very graceful.

### WEeping CARAGANA CARAGANA AB. PENDULA

Also called the upside down tree, since it will only grow down.

10 gal. \$135.00



WALKER  
WEeping  
CARAGANA



YOUNGS WEeping BIRCH

### GRAFTED GLOBE BLUE SPRUCE PICEA PUNGENS GLAUCA 'GLOBOSA'

A flat top, globe-shaped evergreen that holds blue color well during winter months.

### TALLESON'S WEeping JUNIPER SCOPULORUM 'TALLESON'S WEeping'

Has string-like foliage that hangs. Creates an exciting landscape.

### PRICES FOR TOP GRAFTED EVERGREENS

5 gal. \$95.00 10 gal. \$195.00

## FLOWERING SHRUBS

### DWARF BURNING BUSH EUONYMUS ALATA COMPACTA

Very dwarf shrub, known for its fall coloration. Leaves will turn rosy pink in autumn.

### TURKESTAN BURNING BUSH EUONYMUS TURKESTANICA

Dwarf procumbent shrub, evergreen. Leaves are narrow and dark green which turn purple red in fall. The fruit is like a bell, pink in color with red seeds. Does well in shade.

### FIREBALL BURNING BUSH EUONYMUS ALATUS 'SELECT'

Tightly branched compact rounded form. Foliage turning brilliant red in fall.

### CHICAGO FIRE BURNING BUSH EUONYMUS ALATUS 'TIMBER CREEK'

Excellent large shrub for landscape use with mahogany red tones in the summer foliage and fire red fall color.

### NORTHERN GOLD FORSYTHIA FORSYTHIA HYB. NORTHERN GOLD

Upright growing shrub, which is covered with golden yellow flowers before the leaves appear in the spring. This variety is superior to existing cultivars for hardiness.

### SHOW OFF FORSYTHIA FORSYTHIA XINTERMEDIA 'MINDER'

Compact upright growing flowering shrub. Bright yellow blooms first thing in spring.



COTONEASTER HEDGE



DWARF BURNING BUSH

### CARAGANAS PYGMY CARAGANA CARAGANA PYGMAEA

Very neat prostrate shrub with dark green foliage. Has showy pea-like golden yellow flowers.

### FERNLEAF CARAGANA CARAGANA ABORESCENS LOBERGI

This shrub is well known for its feathery foliage and pendulous growth habit.

### GLOBE CARAGANA CARAGANA FRUTEX GLOBOSA

Very dwarf rounded shrub with yellow flowers.

### COTONEASTERS PEKING COTONEASTER COTONEASTER ACUTIFOLIA

Compact upright growing shrub. Very glossy dark green leaves. Can be pruned in any shape.

### PRICES FOR SHRUBS ON THIS PAGE

1 gal. \$13.95      2 gal. \$27.95      5 gal. \$39.95





**SILVER LEAF DOGWOOD**

**ALPINE CURRANT**  
**RIBES ALPINUM**

The finest shrub known for hedges or individual specimen. May be trimmed to any desired shape. Glossy, dark green leaves. Does well in shade.

**FLOWERING CURRANT**  
**RIBES AUREM**

Fragrant yellow flowers in spring with black or orange berries in late summer.

**PRICES FOR SHRUBS ON THIS PAGE**

1 gal. \$13.95      2 gal. \$27.95      5 gal. \$39.95

**DOGWOODS**

**RED OSIER DOGWOOD**

**CORNUS SERICEA**

A broad, erect growing shrub with red branches, grows well in shade.

**SILVER LEAF DOGWOOD**

**CORNUS ALBA MARGINATA**

Known for its silver edge foliage. Branches are blood red.

**GOLDEN VARIEGATED LEAF DOGWOOD**

**CORNUS ALBA GOUCHALTII**

Yellow variegated leaves and red bark.

**YELLOW BARK DOGWOOD**

**CORNUS STOLONIFERA FLAVIRAMEA**

As the name says, the bark is bright yellow. Nice contrast if planted with the red bark ones.

**KELSEY'S DWARF DOGWOOD**

**CORNUS SCRICEA 'KELSEY'**

Compact, dwarf dogwood with shiny green leaves and reddish bark.

**SIBERIAN DOGWOOD**

**CORNUS ALBA SIBIRICA**

Deep green veined foliage with bright crimson bark in winter. Bud's yellow Dogwood Cornus Sericea 'Buds Yellow' Rounded shrubs with green leaves and bright yellow stems.

*All dogwoods should be rejuvenated often as the older canes or branches seem to lose their color.*



**ALPINE CURRANT**



**DIABLO NINEBARK**

**BLACK BEAUTY™ ELDER  
SAMBUCUS NIGRA 'GERDA'**

Hardy with intense purple foliage from spring to fall. Pink spring flowers have a sweet lemon fragrance.

**GOLDEN ELDER  
SAMBUCUS CAN. AUREA**

A fast growing shrub with golden yellow leaves. Should be cut back heavy in the spring.

**GOLDEN PLUME ELDER  
SAMBUCUS PLUMOSO AUREA**

Medium sized shrub with golden yellow cutleaf foliage and red berries.

**RED BERRY ELDER  
SAMBUCUS RACEMOSUS**

Very rapid growing shrub. Useful for a fast screen.

**HONEYROSE HONEYSUCKLE  
LONICERA TATARICA "HONEYROSE"**

An aphid resistant bush honeysuckle, blue green foliage and abundance of deep rosy-red flowers.

**CLAVEY'S DWARF HONEYSUCKLE  
LONICERA X XYLOSTEOIDES 'CLAVEY'S DWARF'**

Compact dwarf shrub with fuzzy, green foliage. Creamy white flowers in summer and red berries in fall.

1 gal. \$13.95      2 gal. \$27.95

**EMERALD MOUND HONEYSUCKLE  
LONICERA XYLOSTEUM**

Low mounded shrub with blue-green foliage, yellow-white flowers, then red berries.

**ARNOLDS RED HONEYSUCKLE  
LONICERA TATARICA 'ARNOLDS RED'**

Has dark green foliage with both red blossoms and fruit.

**MINIGLOBE HONEYSUCKLE  
LONICERA XYLOSTEOIDES MINI GLOBE**

One of the hardiest global honeysuckles. Very interesting foliage.

**AMUR MAPLE  
ACER GINNALA**

Large shrub with deep lobed leaves which turn red in the fall.

**DARTS GOLD NINEBARK  
PHYSOCARPUS OPULIFOLIUS DARTS GOLD**

Dwarf shrub which should be cut back heavy each spring to produce a mass golden yellow leaves throughout the summer.

**DIABOLO NINEBARK  
PHYSOCARPUS OPULIFOLIUS 'DIABLO'**

Low growing shrub with clusters of white flowers in late spring.

**NUGGET NINEBARK  
PHYSOCARPUS OPULIFOLIUS 'NUGGET'**

Compact, dense shrub with new yellow-bronze foliage maturing to lime green.

**COPPERTINA NINEBARK  
PHYSOCARPUS OPULIFOLIUS 'MINDIA'**

Orange-copper foliage in spring matures to dark red.

**CENTERGLOW NINEBARK  
PHYSOCARPUS OPULIFOLIUS 'CENTERGLOW'**

Brighter red than 'Diabolo' and new foliage emerges green.

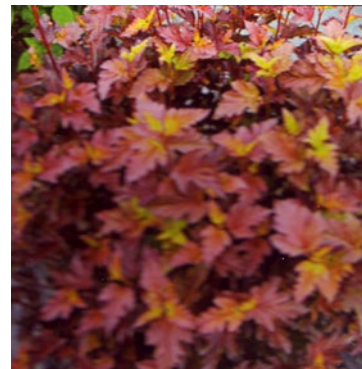

**CENTERGLOW NINEBARK**

## **THE POTENTILLA'S SHRUBBERY CINQUEFOIL BUTTERCUP BUSH**

Potentilla is a very useful plant. It blooms from about mid June until freeze-up. It comes in various colors and heights, upright and more prostrate. Some varieties are suitable for hedges. Once established they are drought resistant and will tolerate poor soils. If too dry they will not die, but will quit blooming. A light pruning in the fall will tidy them up for winter. We have a large selection.

**ABBOTSWOOD** Flowers pure white, medium height, semi-prostrate. HEIGHT 3-4'

**SNOWBIRD** Single white blooms that become double with age. HEIGHT 2-3'

**CORONATION TRIUMPH** This yellow flowering shrub is unique for its star-like flowers. Medium height and upright. Good for hedges. HEIGHT 4-5'

**RED ROBIN POTENTILLA** Compact, dwarf shrub with vigorous, rounded habit and brick-red flowers from spring to frost.

**GOLD DROP** Similar or same as Farrerrii and Hurstborne. Very dense and compact plant produces an abundance of yellow flowers.

**GOLDFINGER** One of the best yellow Potentillas for this area. A profusion of large yellow flowers. Very good for hedge. 4'

**GOLD STAR** Very large yellow flowers, foliage greenish grey. *NEW*. HEIGHT 2-3'

**MANGO TANGO** Compact growing shrub with lovely bi-colored flowers throughout summer.



**RED ROBIN**

**PINK BEAUTY** Rounded shrub with bright green foliage and double, clear pink flowers blooming all summer.

**YELLOW GEM** Flowers are bright yellow and plant is spreading. HEIGHT 1.5'

**RED ACE** Dwarf growing habit, orange flowers, which turn red in cool weather.

**ORANGE WHISPER** Compact uniform mound of green foliage with orange-red continual bloom from late spring to early fall.



**MANGO TANGO**

### **PRICES FOR POTENTILLAS**

1 gal. \$13.95 2 gal. \$27.95 5 gal. \$39.95

**POTENTILLAS PUT COLOR IN YOUR GARDEN**



**GOLDFLAME SPIREA**

**LITTLE PRINCESS SPIREA**

**SPIREA JAPONICA 'LITTLE PRINCESS'**

Small dense shrub that flowers pink in the summer. Turns dark red in the fall.

**DWARF GARLAND SPIREA**

**SPIREA ARGUTA**

Very fine textured foliage, flowers white in spring. Very graceful shrub.

**SNOW WHITE SPIREA**

**SPIREA X SNOW WHITE**

Graceful shrub covered with white flowers in late spring. Hardier than the Bridal Wreath Spirea.

**BRIDAL WREATH SPIREA**

**SPIREA VAN HOUTTEI**

Produces white flowers on arching branches.

**FROEBELI SPIREA**

**SPIREA BUMALDA FROBELIA**

Summer flowering pink spirea.

**ANTHONY WATERER SPIREA**

**SPIREA BUMALDA ANT. WATERER**

A valuable dwarf shrub. Reddish pink flowers from June until freeze-up.

**CRISPA SPIREA**

**SPIREA BUMALDA CRISPA**

A real dwarf shrub with dainty foliage. Flowers reddish pink.

**GOLDFLAME SPIREA**

**SPIREA BUMALDA GOLD FLAME**

Excellent dwarf plant for foundation planting. Ornamental interest throughout the growing season. Golden foliage turning orange red in fall.

**GOLDMOUND SPIREA (LIMEMOUND)**

**SPIREA BUMALDA GOLD MOUND**

Dwarf spirea with yellow foliage. Pink flowers during summer.

**SPIREA SHIROBANA**

**SPIRAEA JAP. SHIROBANA**

Late bloomer with pink and white flowers on same plant.

**SNOWBALL**

**VIBERNUM OPULUS STERILE**

Medium shrub with large white snowball-like flowers.

**HIGHBUSH CRANBERRY**

**VIBURNUM TRILOBUM**

Handsome shrub with maple type leaves. White flowers followed by scarlet berries in fall. Leaves turn red in fall.

**BAILEY COMPACT AMERICAN CRANBERRY**

**VIRBURNUM TRILOBUM 'BAILEY COMPACT'**

Compact form of high bush cranberry with slight red edge on new foliage and deep red colour in autumn.

**BLUE MUFFIN VIBURNUM/ARROWWOOD**

**VIRBURNUM DENTATUM 'CHRISTOM'**

Rounded with white blooms followed by clusters of intense blue berries and yellow fall foliage. Adapts to a wide range of conditions and soil types.

**NANNY BERRY**

**VIBURNUM LENTEGO**

Large upright growing shrub with shiny green leaves which turn reddish purple in fall.

**SUMACS**

**TIGER EYES CUTLEAF STAGHORN SUMAC**

**RHUS TYPLINA 'BAILTIGER'**

New golden form of cutleaf. New growth green turning into yellow. And scarlet in the fall.

**CUTLEAF SMOOTH SUMAC**

**RHUS GLABRA LACINIATA**

Mounded shrub with divided leaves which turn scarlet-red in fall, along with long seed heads. Does well in poor soils.

**GRO LOW FRAGRANT SUMAC**

**RHUS AROMATICA 'GRO LOW'**

Small, fragrant, yellow spring flowers followed by red, hairy fruit in late summer.

**ALL SHRUBS ON THIS PAGE**

1 gal. \$13.95      2 gal. \$27.95      5 gal. \$39.95



**ARGUTA SPIREA**

## **ARCTIC WILLOW**

### **SALIX PURPUREA NANA**

Charming low growing variety with soft blue grey foliage.

## **WOLF WILLOW**

### **ELEAGNUS COMMUTATA**

A small shrub with silver leaves and fragrant yellow flowers. Tolerates poor soils and is drought resistant.

## **MOCK ORANGE**

### **PHILADELPHUS LEW, WATERTON**

A popular hardy shrub with white flowers.

## **SNOWBELLE MOCK ORANGE**

### **PHILADELPHUS 'SNOWBELLE'**

Dwarf upright rounded shrub with small dense leaves. Fragrant white double carnation like flowers in early summer. Most prolific bloomer of all Mockorange.



**CHERRYBOMB BARBERRY**

## **CHERRY BOMB BARBERRY**

### **BERBERIS THUNBERGII 'CHERRY BOMB'**

Wonderful evergreen shrub with deep crimson red foliage on arching stems. 3'x4'

## **ROYAL BURGUNDY BARBERRY**

### **BERBERIS THUNBERGII 'ROYAL BURGUNDY'**

An excellent evergreen shrub with deep burgundy-red foliage on arching stems. 3'x3'

## **CONCORDE BARBERRY**

### **BERBERIS THUNBERGII 'CONCORDE'**

Dwarf globe shaped barberry with a deep purple velvety foliage. 2'x3'

### **PRICES FOR BARBERRIES ONLY**

1 gal. \$16.95      2 gal. \$29.95      5 gal. \$39.95



**MOCK ORANGE**

## **ROSE GLOW JAPANESE BARBERRY**

### **BERBERIS THUNBERGII 'ROSE GLOW'**

Rounded with mottled pink, red, green and white foliage maturing to deep maroon.

## **SUNSATON JAPANESE BARBERRY**

### **BERBERIS THUNBERGII 'MONRY'**

Slow growing compact form. New golden foliage and small yellow flowers in spring.

## **SILVERLEAF BUFFALO BERRY**

### **SHEPHERDIA ARGENTA**

Silver foliage, medium height with scarlet berries in the fall.

## **PURPLE LEAF SANDCHERRY**

### **PRUNUS CISTINA**

A beautiful shrub with rich purple red leaves. Often used as contrast with Potentilla and Golden Elder.

## **NANKING CHERRY**

### **PRUNUS TOMENTSA**

A semi-prostrate shrub to 2.5 metres in height. Flowers are light pink followed with red edible fruit.

### **PRICES FOR THE SHRUBS ON THIS PAGE**

1 gal. \$13.95      2 gal. \$27.95      5 gal. \$39.95

**FLOWERING AND  
ORNAMENTAL SHRUBS**

**LILACS**

Lilacs produce an abundance of flowers in spring and summer, filling the air with delicate fragrance. The French Hybrids bloom early and the Preston Hybrids and Amur lilac are the late flowering ones.

**FRENCH HYBRIDS**

<b>CHARLES JOLY</b>		Double purple red.
<b>SOUVL DE L. SPAITH</b>		Purple.
<b>MADAM LEMOINE</b>		Double white.
<b>SENSATION</b>		Purple with white edges.
<b>PRESTON HYBRIDS</b>	<b>WILL NOT SUCKER</b>	
<b>ROYALTY</b>		Purple.
<b>MISS KIM</b>		Lavender Blue.
1 gal. \$12.95	2 gal. \$26.95	5 gal. \$36.95

**RUSSIAN ALMOND**

**PRUNUS TENELLA**

One of the earliest flowering shrubs. Flowers are deep pink and appear before the leaves.

**DOUBLE FLOWERING ALMOND**

**PRUNUS TRILOBA MULTIPLEX**

Also known as Rose Tree of China. A handsome, hardy, large shrub with double pink flowers in early spring.

**PRICES FOR THE ABOVE**

1 gal. \$13.95	2 gal. \$27.95	5 gal. \$39.95
----------------	----------------	----------------



**DOUBLE FLOWERING ALMOND**



**FRENCH SENSATION LILAC**

**VINES & CLIMBERS**

<b>VIRGINIA CREEPER</b>	<b>ENGELMAN IVY</b>
<b>DROPMORE SCARLET HONEYSUCKLE</b>	
<b>GOLDFLAME HONEYSUCKLE</b>	<b>VALIANT GRAPE</b>

**PRICES FOR CLIMBING VINES**

1 gal. \$13.95	2 gal. \$27.95
----------------	----------------

**JACKMANI CLEMATIS**

**VILLE DE LYON CLEMATIS**

**PRICES FOR CLEMATIS**

1 gal. \$18.95
----------------



**DROPMORE SCARLET HONEYSUCKLE**

## HARDY SHRUB ROSES

### ADELAIDE HOODLESS

Deep red, glossy foliage.

### AUSTRIAN COPPER

Yellow and copper color. Do not prune this one as other roses, as it blooms on second year wood.

### BLANC DE COUBERT

White, double flowers, continued bloomer.

### CUTHBERT GRANT

Double dark red.

### F.J. GROOTENDORST

Continual small double pink carnation like blooms.

### HANSA

Double red, fragrant, hardiest of all shrub roses.

### JOHN CABOT

Medium red, can be used as a climber.

### MORDEN AMORETTE

Dwarf, red flowers.

### MORDEN FIRE GLOW

Orange red.

### MORDEN RUBY

Ruby red, very interesting.

### MORDEN SUNRISE

Compact shrub with semi-double yellow, orange, and peach flowers.

### PERSIAN YELLOW

Yellow. Do not prune too heavy. This one also blooms on two year old wood.

### THERESA BUGNET

Pink.

### RED LEAF

Pink flowers with purple leaves.



BLANC DE COUBERT



MORDEN FIRE GLOW

### WINNIPEG PARKS

Compact dwarf rose, flowers red disease resistant.

### J.P. CONNELL

Very hardy, yellow flowers in June.

### MORDEN BLUSH

Light pink blossoms.

### PRICES FOR ROSES

1 gal. \$13.95

2 gal. \$27.95

### LANDSCAPE ADVICE

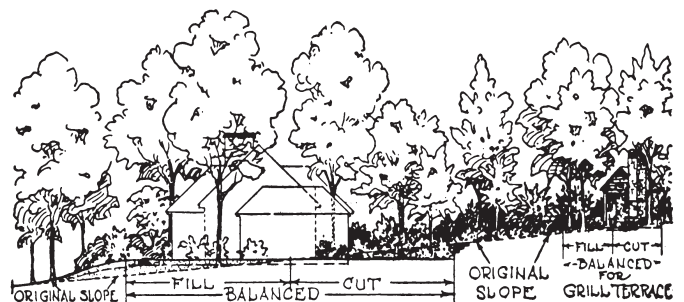
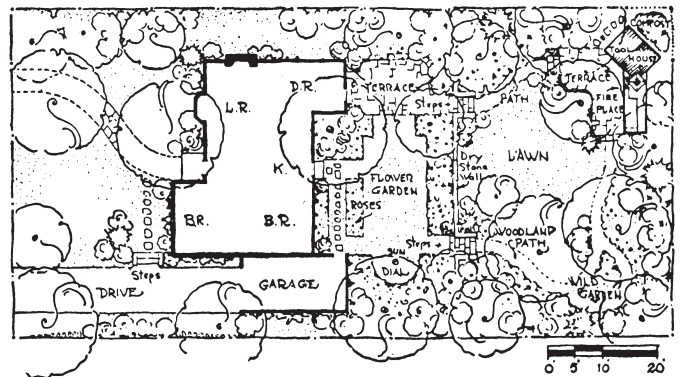

## APPLES AND APPLECRABS



**GOODLAND APPLE**

**HARCOURT** Large sized eating apple. Fruit striped red. SEPTEMBER.

**GOODLAND** Large fruit, mostly green. Good for eating and cooking. LATE SEASON.

**HARALSON** Large red apple, good tasting, excellent keeper. LATE SEASON.

**ZESTAR APPLE** Early season apple that's juicy with a light crisp texture.

**PARKLAND** Very good eating apple. EARLY.

**NORKENT APPLE** Medium sized round green apple streaked with red color. Slightly russeted. A crisp sweet aromatic apple. Ideal for eating fresh and cooking. Ripens early September. Keeps for up to 12 weeks.

**SEPTEMBER RUBY** Very good red apple. Good keeper. LATE SEASON.

**RED SPARKLE** Hardy red apple, high quality with excellent flavour. EARLY.

**DOLGO** Small oval red fruit. Best for jelly. MID-SEASON.

**KERR** Deep red fruit. Good for dessert and jelly. LATE SEASON.

**HEYER #12** Medium sized round greenish yellow fruit. Very good for pie and sauce. EARLY.

**BATTLEFORD** Medium to large greenish yellow fruit, striped red. MID-SEASON.

**HONEY CRISP™ APPLE** Large sized red apple that is exceptionally crisp, sweet and juicy, making it a must for any home or commercial orchard. It's fine texture makes it great for fresh eating. Ripens late September. Exceptional storage life. A 1991 University of Minnesota introduction.

**HARDI- MAC APPLE** Medium size bright red fruit with white crispy, juicy, aromatic flesh and a distinctive flavour. Hardy apple for eating fresh or baking. Ripens mid-September. Stores moderately well. A selection of the historical McIntosh Apple found in Calgary, Alberta in 1992.

**FALL RED** Dark red fruit, taste slightly as 'Mc Intosh' variety. Matures mid September. Excellent eating. Stores well.

### PRICES FOR APPLE TREES

5 gal. \$69.95      7 gal. \$93.95      10 gal. \$129.95



**HONEYCRISP APPLE**



## **PLUM TREES**

- BROOKGOLD PLUM** Good eating plum, with golden yellow fruit.
- BROOKRED PLUM** Dark red fruit with red flesh. Good for jam and jelly.
- OPATA PLUM** Deep purple fruit. Ripens late August, makes good jelly.
- PEMBINA PLUM** One of the best eating plums. Compares to the greengage plum.
- TECHUMSEH PLUM** Large red plum, fruit is round. Excellent flavour. EARLY.

## **PEAR TREES**

- GOLDEN SPICE PEAR** Very hardy, grows rapidly. Ripens late September.
- EARLY GOLD PEAR** Early maturing green-gold fruit for fresh eating and preserves. Glossy green leaves turn yellow to purple in autumn.
- URE PEAR** Hardy tree. Flowers are large, white and very showy. Fruit is small.

### **PRICES FOR ABOVE FRUIT TREES**

5 gal. \$69.95 7 gal. \$93.95 10 gal. \$129.95

## **SMALL FRUIT**

- CHOCKECHERRY**
- MARDEN SAND CHERRY** Black fruit, good for jelly.
- NANKING CHERRY** Red fruit.
- BLUEBERRY**
- WHITE CURRANT**
- RED CURRANT**
- BLACK CURRANT**
- GOOSEBERRY**
- SASKATOON**

### **PRICES FOR SMALL FRUIT**

1 gal. \$13.95 2 gal. \$27.95

### **RHUBARB CANADA RED (STRAWBERRY RED)**

1 gal. \$6.50 2 gal. \$13.50



**CUPID CHERRY**

## **CHERRY TREES**

- CUPID CHERRY** Large dark red to black cherries are sweet with firm textured flesh.
- JULIET CHERRY** Dark red fruit, excellent for eating.
- ROMEO CHERRY** Self pollinating early producing. Medium sized deep red fruit with sweet flesh.
- EVANS CHERRY** Medium sized tree with shiny red fruit. Sweet tartness flavour, great for pies, jams, and jellies.
- VALENTINE CHERRY** Produces a scarlet red tart cherry.
- RASPBERRY BOYNE, DOUBLE DELIGHT** Bare root \$25.00 per 10



**BOYNE RASPBERRY**

## **BAREROOT WINDBREAK TREES**

**Brooks Poplar  
Sargent Poplar  
Tower Poplar**

**Tristis Poplar  
Assiniboine Poplar  
Prairie Sky Poplar**

**Green Ash  
Russian Olive  
Laurel Leaf Willow**

## **HEDGES**

**Caragana  
Villosa Lilac**

**Cotoneaster  
Common Lilac**

**Nanking Cherry  
Saskatoon**

**Bareroot trees and shrubs are sold between April 5 and June 1.  
Prices for bareroot on request.**

**WE HAVE HEDGING PLANTS AVAILABLE IN 1 GALLON POTS FOR SUMMER PLANTING.  
AT QUANTITY DISCOUNTS.**



**GOLDSTAR POTENTILLA**



**SNOWBALL**



**OSIER DOGWOOD IN WINTER**



**MORDEN SUNRISE ROSE**



***At Coaldale Nurseries we also sell firewood.***

We will be happy to help you select the firewood that works best for you.

For inside fireplaces we recommend birch or fir firewood. It burns longer, cleaner and gives off more heat.



But if you like a crackling fire you might want to go with pine.

Or for a more affordable wood try the poplar.

Firewood can be bought in small or large quantities.

All cut and split and ready for you to use.

# Coaldale Nurseries Ltd.

Box 1267, Coaldale, AB T1M 1N1  
Phone: 403-345-4633 • Fax: 403-345-2866



The WARWICK PRINTING Co. Ltd.

Plant a tree for the future...

To: \_\_\_\_\_  
\_\_\_\_\_  
\_\_\_\_\_  
\_\_\_\_\_  
\_\_\_\_\_

